



18SE

Semi Electric Truck 1.8t
New Choice of Entry-level Electric Pallet Truck

NEW FEATURE

Performance

The innovative PMM (Permenant Magnet Motor) technology provides reliable and energy saving solutions. MOLEX/AMP connectors and durable electric wires greatly reduce malfunctons of components. Auto "SLEEP" mode protects batteries.

Patented Design:

New integrated control head design. Electrical layout patent.

Operation:

Ergonomically-designed tiller head helps increase efficiency; internal charger for easy charging. Adopt hand pallet truck lifting system, perfect for start-level operator

Safety:

Handy emergency disconnect button and durable driving unit ensure safety under any situation. Emergency reverse belly button protects the operator from getting hurt.

Maintenance:

Assembly components, easy for diagnosis and replacing.

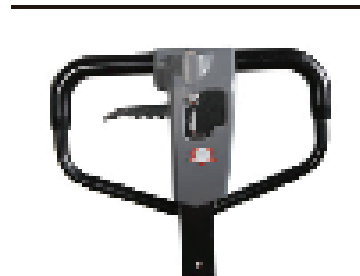

Distinguishing Mark

1.2	Model designation			18SE
1.3	Drive unit			Battery
1.4	Operator type			Walkie
1.5	Rated capacity	Q	kg	1800
1.6	Load center distance	c	mm	600
1.8	Load distance	x	mm	882/946
1.9	Wheelbase	y	mm	1169/1233
Weight				
2.1	Service weight (include battery)		kg	145
2.2	Axle loading, laden driving side/loading side		kg	620/1325
2.3	Axle loading, unladen driving side/loading side		kg	115/30
Types, Chassis				
3.1	Tyre type, driving wheels / loading wheels			PU / PU
3.2	Tyre size, driving wheels (diametre x width)		mm	210 x 70
3.3	Tyre size, loading wheels (diametre x width)		mm	2x 80 x 60 (74 x 88)
3.5	Wheels, number driving, caster/loading (x=drive wheels)		mm	1 x /4
3.7	Track width, rear, driving side	b ₁₁	mm	410 (535)
Dimensions				
4.4	Lift height	h ₃	mm	115
4.9	Height drawbar in driving position min./max.	h ₁₄	mm	715/1280
4.15	Lowered height	h ₁₃	mm	85(75)
4.19	Overall length	l ₁	mm	1613
4.20	Length to face of forks	l ₂	mm	463
4.21	Overall width	b ₁ /b ₂	mm	560(685)
4.22	Fork dimensions	s/ e/ l	mm	50/150/1150
4.25	Distance between fork-arms	b ₅	mm	560/685
4.32	Ground clearance, center of wheelbase	m ₂	mm	35(25)
4.34.1	Aisle width for pallets 1000 x 1200 crossways	Ast	mm	1684
4.34.2	Aisle width for pallets 800 x 1200 lengthways	Ast	mm	1884
4.35	Turning radius	Wa	mm	1430
Performance data				
5.1	Travel speed, laden/ unladen	km/h	km/h	3.5/4
5.2	Lifting speed, laden/ unladen		m/ s	10mm / time
5.3	Lowering speed, laden/ unladen		m/ s	manual lowering
5.8	Max. gradeability, laden/unladen		%	5/10
5.10	Service brake type			Electromagnetic
Electric-engine				
6.1	Drive motor rating S2 60min		kW	0.65
6.2	Lift motor rating at S3 15%		kW	Manual Lifting
6.3	The maximum allowed size battery		mm	185/125/190
6.4	Battery voltage/nominal capacity K20		V/Ah	12*2/30Ah
6.5	Battery weight		kg	9.5*2
Additional data				
8.1	Type of drive control			DC
10.5	Steering type			Mechanical
10.7	Sound pressure level at the driver's ear		dB(A)	74

1. The parameters in the table are of the standard model. For more information, please contact us.
2. The parameters are subject to change without notice.

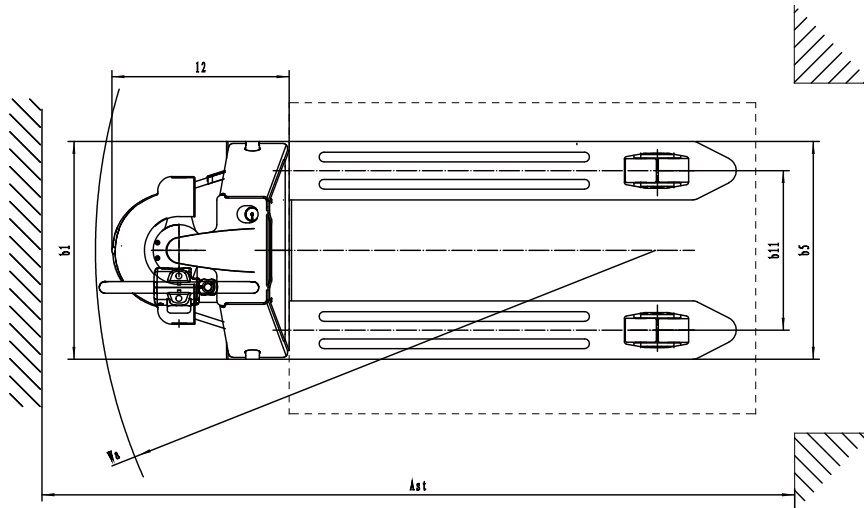
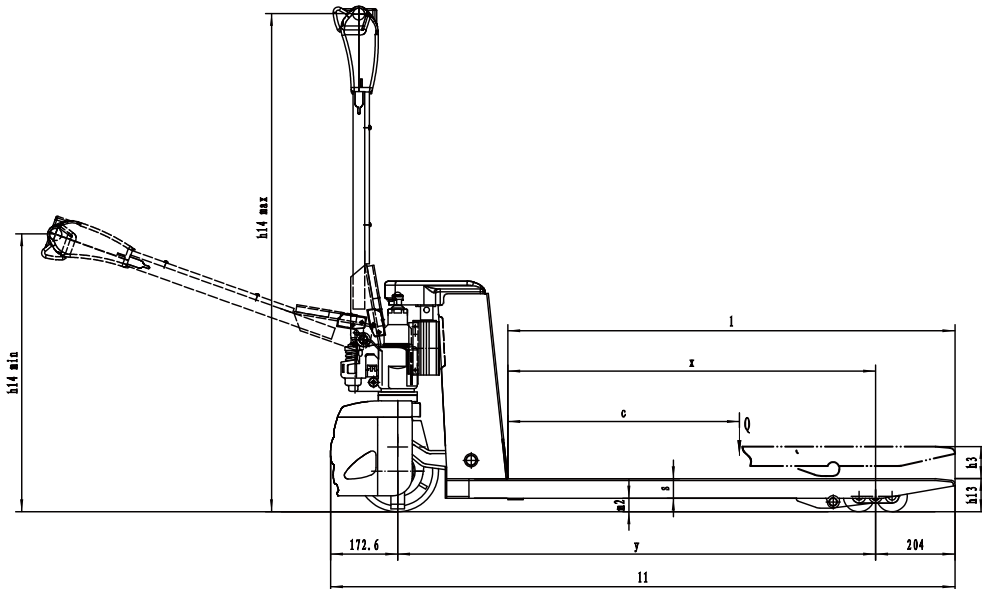

Options

Options	Type	18SE
Fork length		¡ 700 ~ 1500
Fork width	Ground Clearance 40mm	¡ 280/520
	Regular	¡ 520/600
Single load wheel	Ground clearance 40mm	-
	Ground clearance 75mm	¡
Driving Wheel		¡ PU wheel with Pattern
Balance Wheel	Regular	-
	Ground clearance 75mm	Regular: ¡ Fork width > 280 Fork length > 1400: l
Fork lowered height		¡ 40mm (capacity < 1000Kg)
Handle of 12ez	Ground clearance 40mm	l
	Regular	¡

Note: Regular: Fork length <1400, capacity 1.8T; Fork length ≥1400, capacity 1.2T; ground clearance: capacity 1.0T

Note: l standard ¡ option - NA



Hyundai Tower, Level 1, 394 Lane Cove Road,
Macquarie Park NSW 2113
Phone: 1300 760 030
info@hyundai-materialhandling.com.au
www.hyundai-materialhandling.com.au